



For Air

Purge Plug

For air lines with purge mechanism

Working pressure  1.0 MPa (10 kgf/cm ²)	Valve structure  Purge valve	Applicable fluid  Air Inert gas
---	--	--

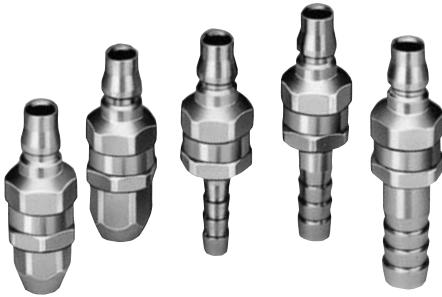

Eliminates unpleasant pop and hose whipping motion when Cupla is disconnected.

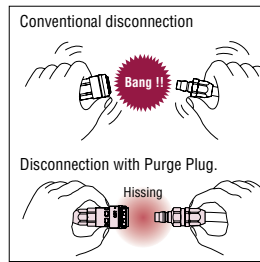

- When the Cupla is disconnected, the pressure left in the hose is released gradually, eliminating unpleasant noise and hose whip back.
- Unique design of air purge system enables the residual pressure release quickly and quietly.
- A unique but simple purge valve design is good for long and repeated use.
- The function is assured even under a high supply pressure or with a long hose.

Note: This product is not a check valve to totally stop the air flow.

Specifications

Body material	Steel (Chrome-plated)			
Size	1/4" • 3/8" • 1/2"			
Working pressure MPa (kgf/cm ²)	1.0 (10)			
Pressure resistance MPa (kgf/cm ²)	1.5 (15)			
Seal material	Seal material	Mark	Working temperature range	Remarks
Working temperature range	Nitrile rubber	NBR (SG)	-5°C~+60°C	Standard material

Tightening Torque Range

N·m {kgf·cm}

9~11 {92~112}

Flow Direction

Fluid must run from socket to plug.



Interchangeability

Can be connected with plugs for Hi Cupla Models 20, 30 and 40. Interchangeable with each corresponding Hi Cupla Series models.

Min. Cross-Sectional Area (mm²)

Model	PV-20PH	PV-30PH	PV-40PH	PV-65PN	PV-85PN
Min. Cross-sectional Area	19.6	44.1	50.4	22.0	44.1

Suitability for Vacuum

Not suitable for vacuum application in either connected or disconnected condition.

Pressure - Flow Characteristics

[Test conditions] •Fluid : Air •Temperature : Room temperature

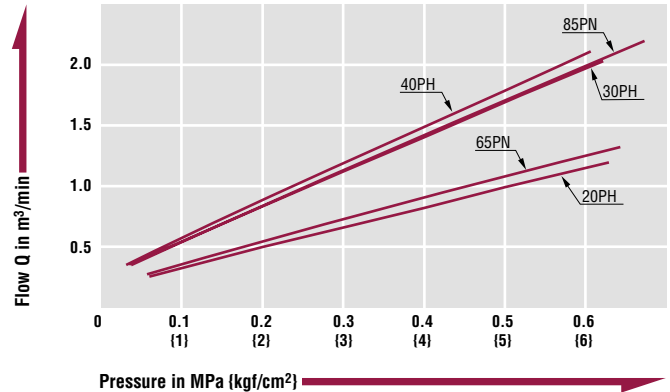

Models and Dimensions

WAF : WAF stands for width across flats.

Plug PH type (Hose barb)

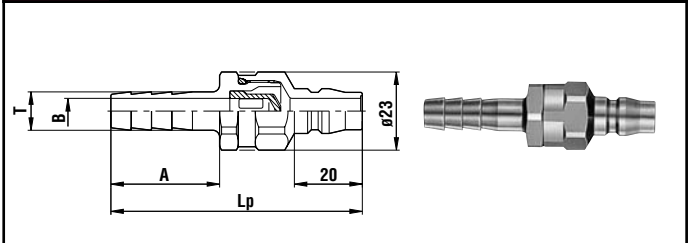

Model	Application (Hose)	Mass (g)	Dimensions (mm)			
			Lp	A	øB	øT
PV-20PH	1/4"	59	70	28	5	8.4
PV-30PH	3/8"	62	74	32	7.5	11.3
PV-40PH	1/2"	76	77	35	9	14.8

Plug PN type (For urethane hose with spring nut connection)

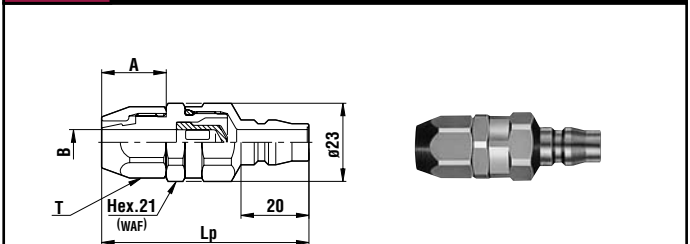

Model	Application (Hose)	Mass (g)	Dimensions (mm)			
			Lp	A	øB	T(WAF)
PV-65PN	ø6.5 mm x ø10 mm	71	59	17	5.3	Hex.17
PV-85PN	ø8.5 mm x ø12.5 mm	78	61	19	7.5	Hex.19