

For Air

# Rotary Plug

For pneumatic tools and devices

Working pressure



Valveless

Applicable fluid

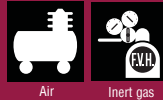

Comparison by appearance

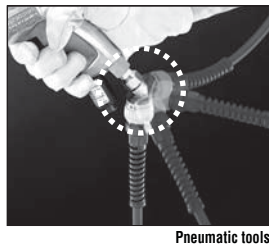
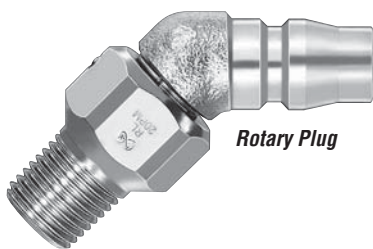

Pneumatic tools

Newly developed rotary function allows 360° swivelling!  
Big improvement for handling of pneumatic tools!

- Rotary neck plug for hose connection to pneumatic tools and pneumatic devices.
- Fits at 45° angle to the tool eliminating annoying offset load caused by connected hose.
- Ideal compact design enables optimum workability by simple body structure. Now far lighter and smaller than conventional models.
- New dust-proof design for increased durability.
- For air tackers, nailers, impact wrenches and other pneumatic tools.

## Specifications

Body material	Steel (Nickel-plated)				
Size	1/4" • 3/8"				
Working pressure MPa (kgf/cm <sup>2</sup> )	1.5 (15) / 1.0 (10) (only RL-02PM • PFF type)				
Pressure resistance MPa (kgf/cm <sup>2</sup> )	2.0 (20) / 1.5 (15) (only RL-02PM • PFF type)				
Seal material	Seal material	Mark	Working temperature range	Remarks	
Working temperature range	Nitrile rubber	NBR (SG)	-5?C--+60?C	Standard material	

## Max. Tightening Torque

N·m {kgf·cm}

Size	R 1/4	R 3/8
Torque	15 (153)	25 (255)

## Interchangeability

- Model RL-20PM • RL-30PM • RL-20PFF: Can be connected with sockets of Hi Cupla Models 20, 30 and 40 and interchangeable with each corresponding Hi Cupla Series models.
- Model RL-02PM • RL-02PFF: Can be connected with sockets of Super Cupla.

## Models and Dimensions

WAF : WAF stands for width across flats.

### Plug PM type (Male thread)

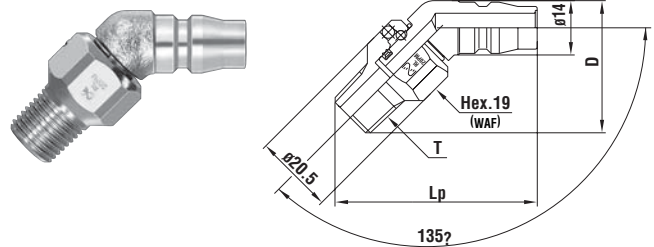

Model	Application	Mass (g)	Dimensions (mm)		
			Lp	D	T
RL-20PM	Rc 1/4	52	52.1	34.1	R 1/4
RL-30PM	Rc 3/8	73	50.8	32.8	R 3/8

### Plug Model RL-20PFF type (Female thread)

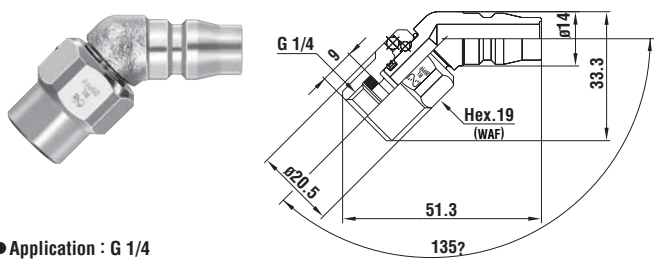

- Application : G 1/4
- Mass : 57g

Dimensions (mm)

### Plug Model RL-02PM type (Male thread)

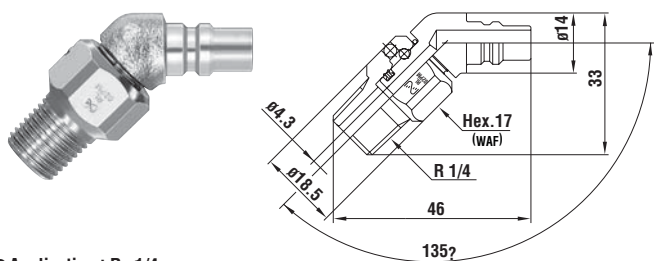

- Application : Rc 1/4
- Mass : 50g

Dimensions (mm)

### Plug Model RL-02PFF type (Female thread)

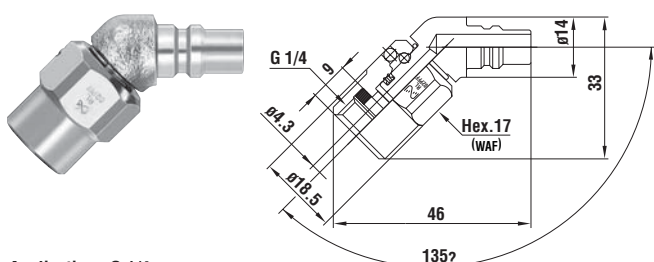

- Application : G 1/4
- Mass : 55g

Dimensions (mm)

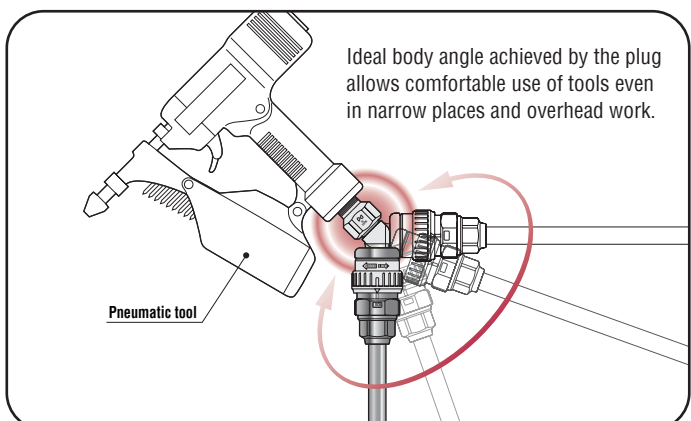

Ideal body angle achieved by the plug allows comfortable use of tools even in narrow places and overhead work.

Before use, please be sure to read "Safety Guide" described at the end of this book and "Instruction Sheet" that comes with the products.