

A-30A DRILL MOTOR

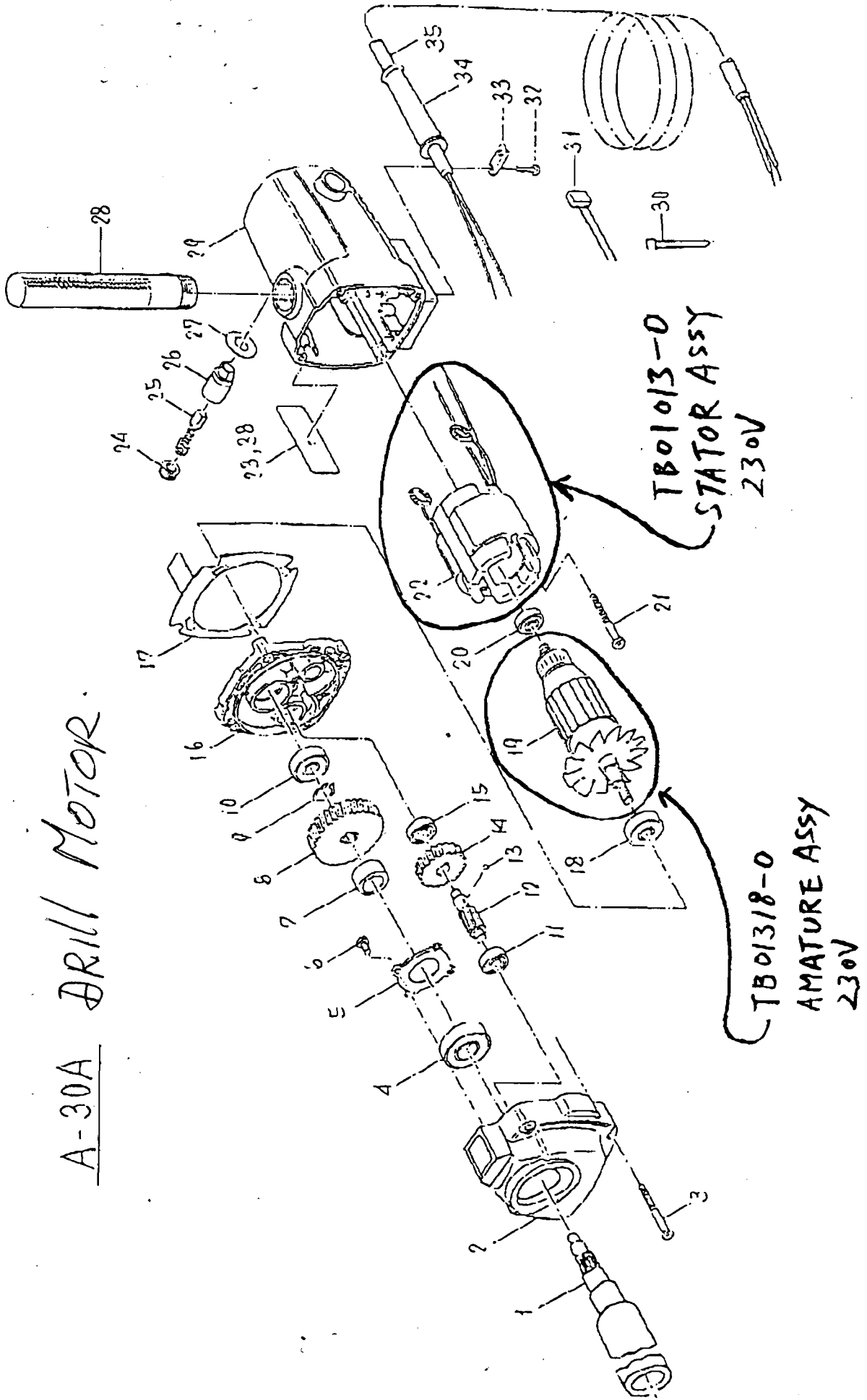



SPARE PARTS LIST
FOR
DRILL MOTOR ASSY (TB01130) OF A-30A

April 25, 1994

| REF. NO. | PARTS NO. | PARTS NAME | UNIT FOB PRICE IN YEN |
|-------------|--------------|---|--------------------------|
| 1 | TQ01136* | SPINDLE ARBOR | |
| 2 | TQ01137 | GEAR CASE | |
| 3 | TQ01856* | + SCREW 5 X 50 | |
| 4 | TP01632 | BALL BEARING 6203Z | |
| 5 | TQ00850 | BEARING HOLDER | |
| 6 | TQ00859 | + PAN HEAD SCREW 5X10 | |
| 7 | TQ00860 | COLLAR | |
| 8 | TQ00861 | SPIRAL GEAR(B) | |
| 9 | TP18358 | RETAINING RING C 14 (USE NO 03A473) | |
| 10 | TP08828 | BALL BEARING 6200 | |
| 11 | TP00468 | BALL BEARING 608ZZ | |
| 12 | TQ00862 | PINION | |
| 13 | TP08393 | SUNK KEY 3 X 3 X 5 | |
| 14 | TQ00863 | SPIRAL GEAR (A) | |
| 15 | TP00468 | BALL BEARING 608ZZ | |
| 16 | TQ00864 | BEARING BRACKET | |
| 17 | TQ01436 | WIN-SHIELD PLATE | |
| 18 | TP17438 | BALL BEARING 6200Z | |
| 19 | TB01318* | ARMATURE ASSY 230V | |
| | N/A | ARMATURE ASSY 115V | |
| 20 | TP00468 | BALL BEARING 608ZZ | |
| 21 | TQ01850* | + PAN HEAD SCREW 5 X 50 | |
| 22 | TB01013 | STATOR ASSY 230V | |
| | N/A | STATOR ASSY 115V | |
| 23 | TQ01858 | NAMEPLATE 230V | |
| 24 | TQ00867 | BRUSH CAP | |
| 25 | TR00598 | CARBON BRUSH ASSY CAN USE TB00777. | |
| 26 | TB00868 | BRUSH HOLDER DIS. 608Z. | |
| 27 | TQ00869 | INSULATION WASHER | |
| 28 | LB00805 | SIDE HANDLE ASSY | |
| 29 | TQ00870 | STATOR SPIDER | |
| 30 | LP13171 | CABLE TIE 100 | |
| 31 | TP16481 | CONDENSER | |
| 32 | LP30251 | + PAN HEAD SCREW 4 X 16 | |
| 33 | TP13362 | CORD CLAMP | |
| 34 | TP13363 | CORD ARMOR | |
| 35 | TQ01440 | CORD FOR MOTOR | |

* New parts for A-30A only.